

THIS MAP IS FOR THE PURPOSE OF AD VALOREM TAXATION ONLY.

Ptn. Tract No. 14083-1, M.B. 231/22-25

City of Chino
Tax Rate Area
1001

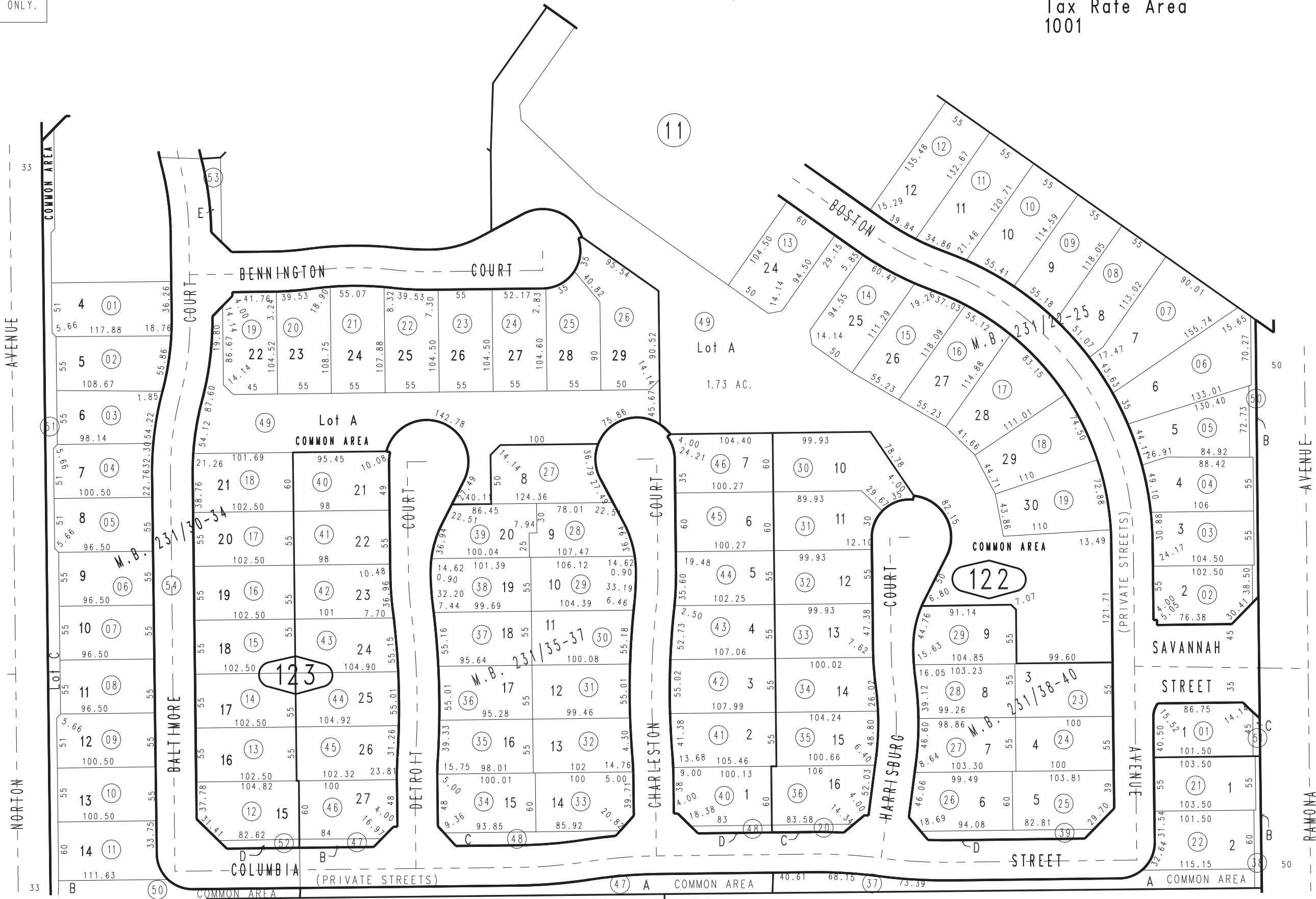

NOV. 1971

Tract No. 14083, M.B. 231/38-40
Tract No. 14083-4, M.B. 231/35-37
Ptn. Tract No. 14083-3, M.B. 231/30-34

Ptn. N.W.1/4, Sec. 10
T.2S., R.8W.

Assessor's Map
Book 1019 Page 12
San Bernardino County

REVISED
04/01/09 TY