

THIS MAP IS FOR THE PURPOSE OF AD VALOREM TAXATION ONLY.

N.1/2, N.E.1/4, Sec.14, T.9N.,R.2W., S.B.B.&M.

Barstow Unified Tax Rate Area 56006

0427-30

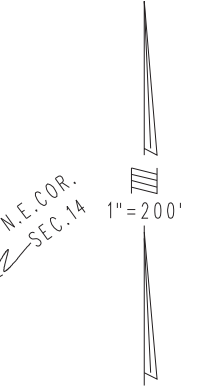

Parcel Map No. 8700, P.M. 93/64-65
Parcel Map No. 8184, P.M. 86/21
Ptn. Parcel Map No. 5454, P.M. 51/93
Parcel Map No. 4217, P.M. 38/70-71
Parcel Map No. 3110, P.M. 28/50
Parcel Map No. 771, P.M. 7/9

Parcel Map No. 16902, P.M. 231/34-35
Parcel Map No. 13146, P.M. 160/88-89
Parcel Map No. 8701, P.M. 97/27-28

Assessor's Map
Book 0427 Page 30
San Bernardino County

REVISED
05/05/15 BK-MC
09/02/16 KC-MC