

THIS MAP IS FOR THE PURPOSE OF AD VALOREM TAXATION ONLY.

City of Hesperia  
Tax Rate Area  
20090

0413 - 17



1" = 200'

Ptn. Tract No. 4482, M.B. 56/22-25

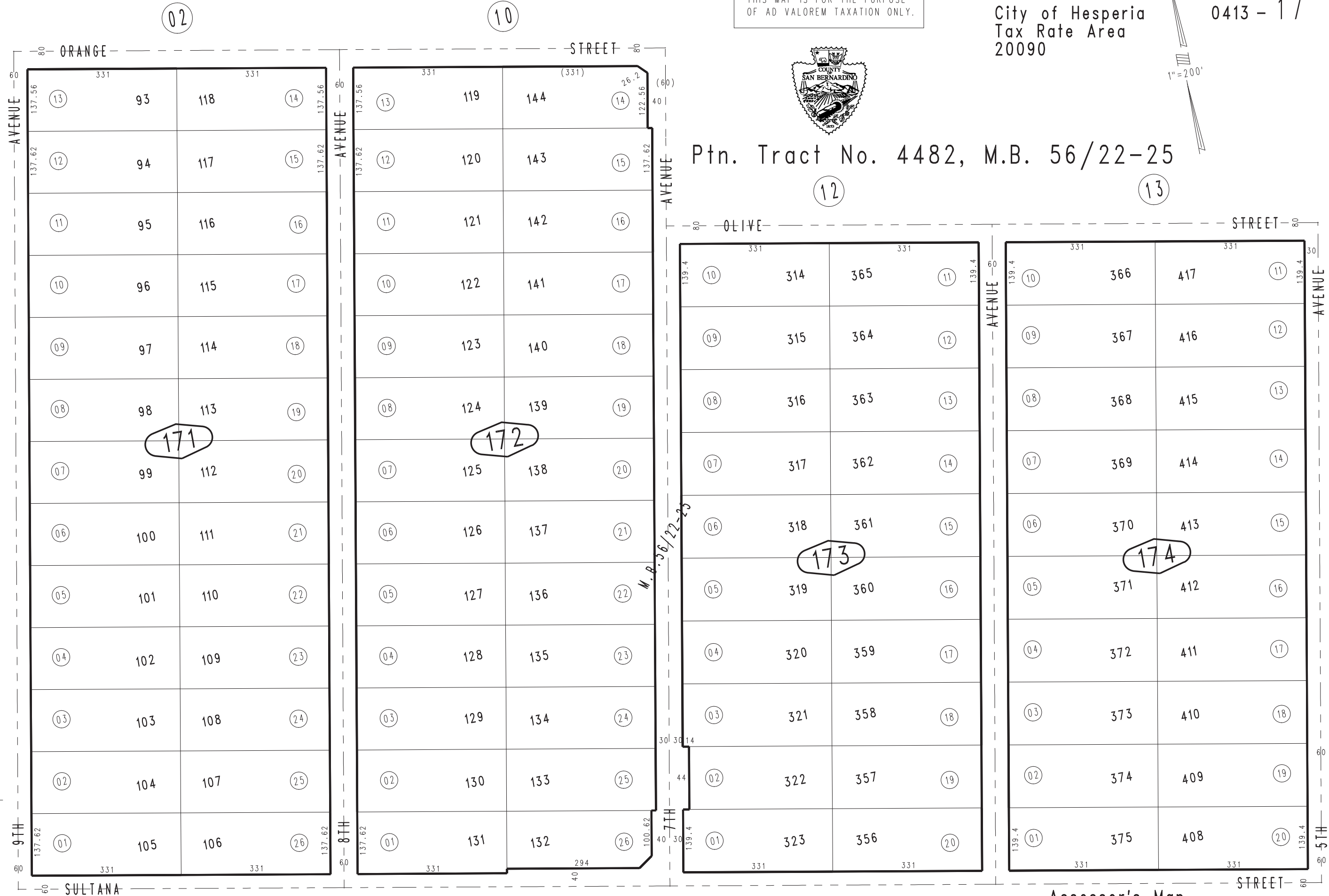

REVISED

April 2004

Ptn. S.W.1/4, Sec. 20  
T.4N., R.4W.

Assessor's Map  
Book 0413 Page 17  
San Bernardino County