

THIS MAP IS FOR THE PURPOSE  
OF AD VALOREM TAXATION ONLY.



Ptn. Tract No. 5180, M.B. 62/1-5

City of Hesperia  
Tax Rate Area  
20090

0399-04

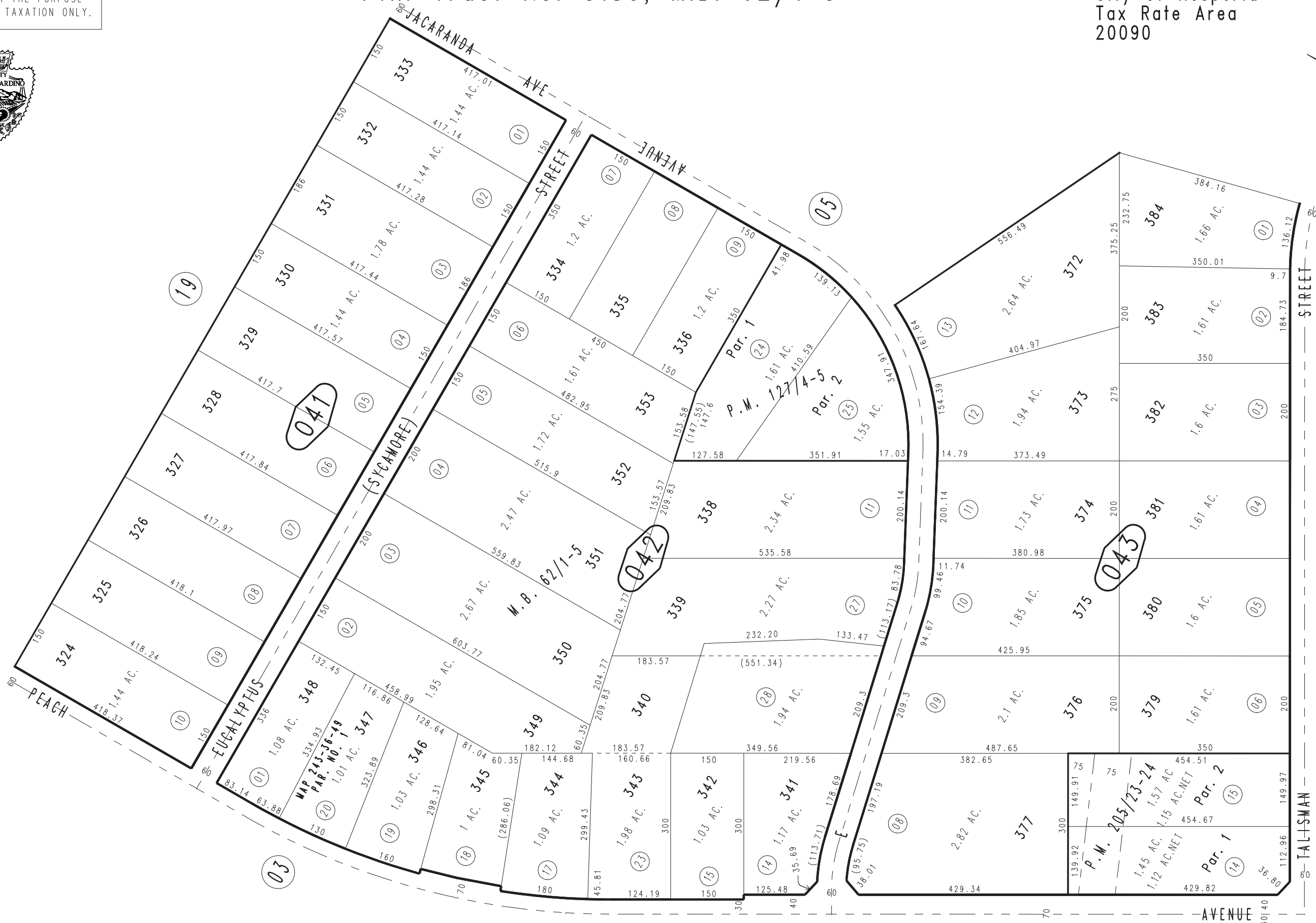
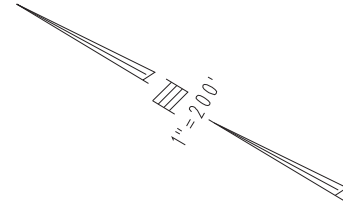

April 2004

Parcel Map No. 16253, P.M. 205/23-24  
Parcel Map No. 10942, P.M. 127/4-5

Ptn. N.E.1/4, Sec. 11  
T.4N., R.4W.

Assessor's Map  
Book 0399 Page 04  
San Bernardino County

REVISED  
03/08/13 LH  
03/09/13 LH