

THIS MAP IS FOR THE PURPOSE OF AD VALOREM TAXATION ONLY.



Ptn. Tract No. 5543, M.B. 66/13-34

City of Hesperia Tax Rate Area 20033

0398-06

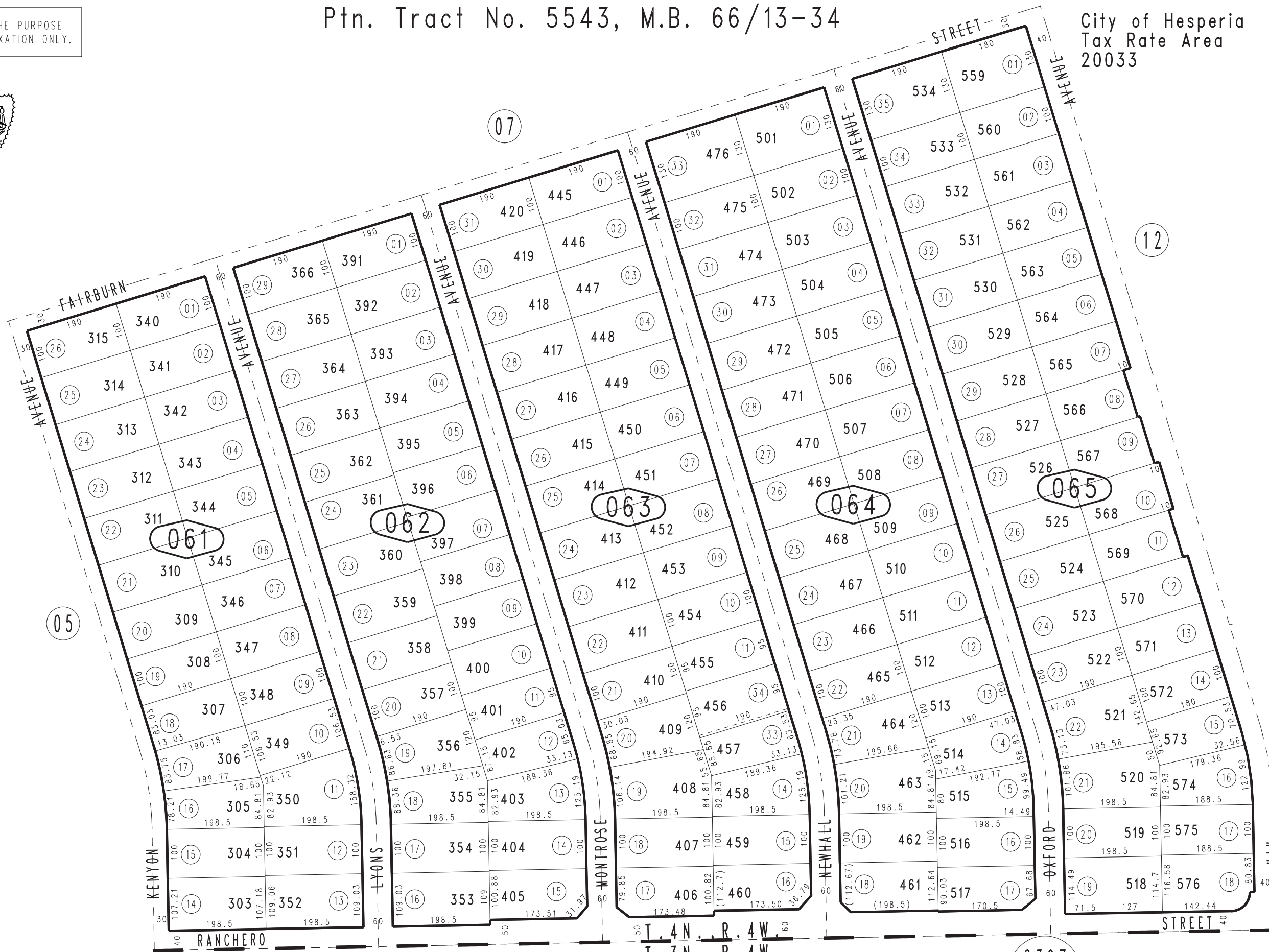

0397
09

0397
06

0397
01

Ptn. S.E. 1/4, Sec. 34
T.4N., R.4W.

Assessor's Map
Book 0398 Page 06
San Bernardino County