

THIS MAP IS FOR THE PURPOSE OF AD VALOREM TAXATION ONLY.

Ptn. N.E.1/4 Sec.26, Ptn. N.W.1/4 Sec.25, T.2N.,R.4W., S.B.B.&M.

0340-15



Rim of The World Unified Tax Rate Area 105011

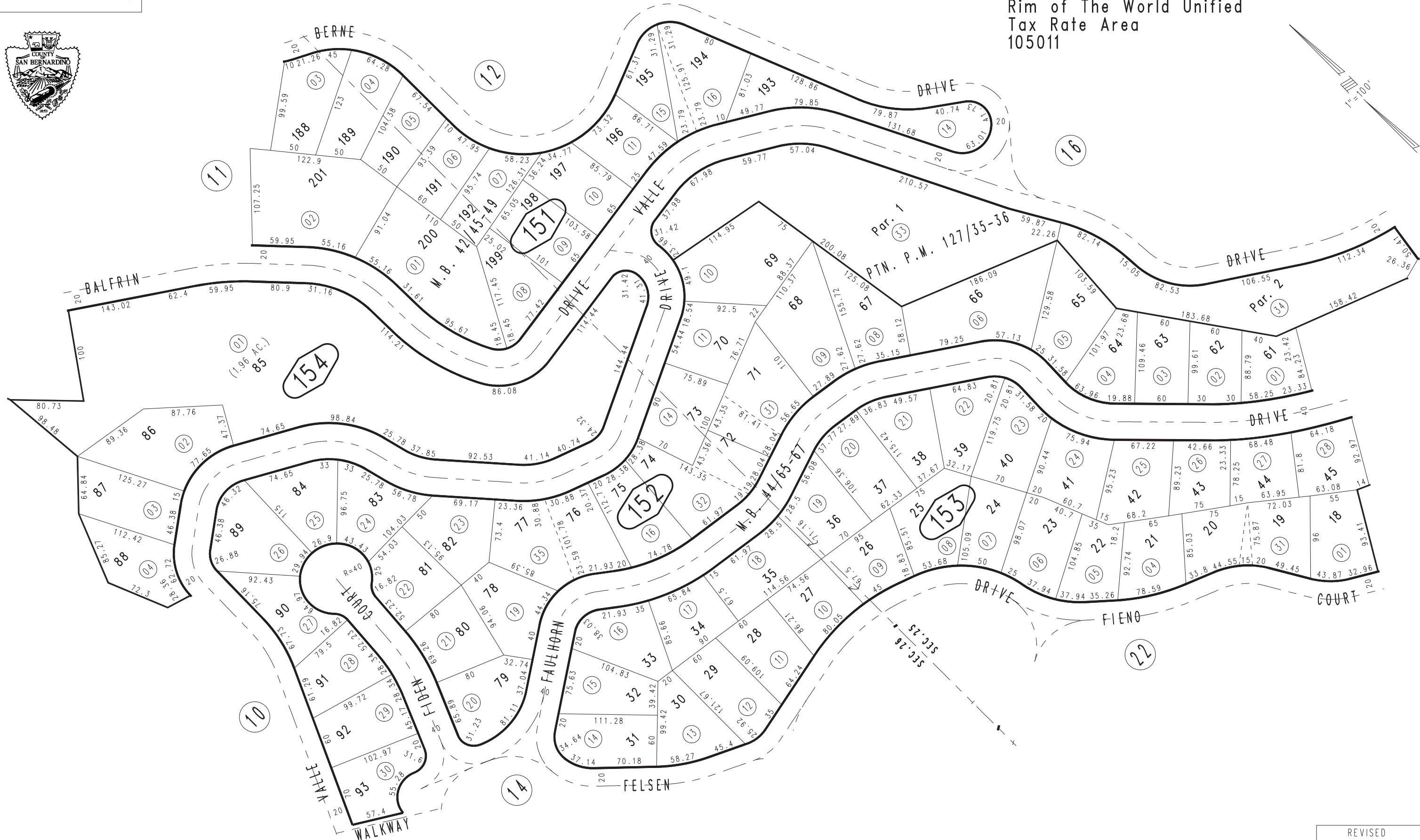
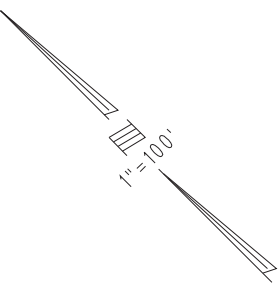

May 2005

Ptn. Tr. No. 3108, Switzerland Sub. No. 11, M.B. 42/45-49
Ptn. Tr. No. 3222, Switzerland Sub. No. 14, M.B. 44/65-67

Ptn. Parcel Map No. 10574, P.M. 127/35-36

Assessor's Map
Book 0340 Page 15
San Bernardino County

REVISED
08/27/18 KC