

THIS MAP IS FOR THE PURPOSE
OF AD VALOREM TAXATION ONLY.

Ptn. E.1/2 Sec.22&27, T.2N.,R.4W., S.B.B.&M.

Rim of The World Unified
Tax Rate Area
105013

0338-24

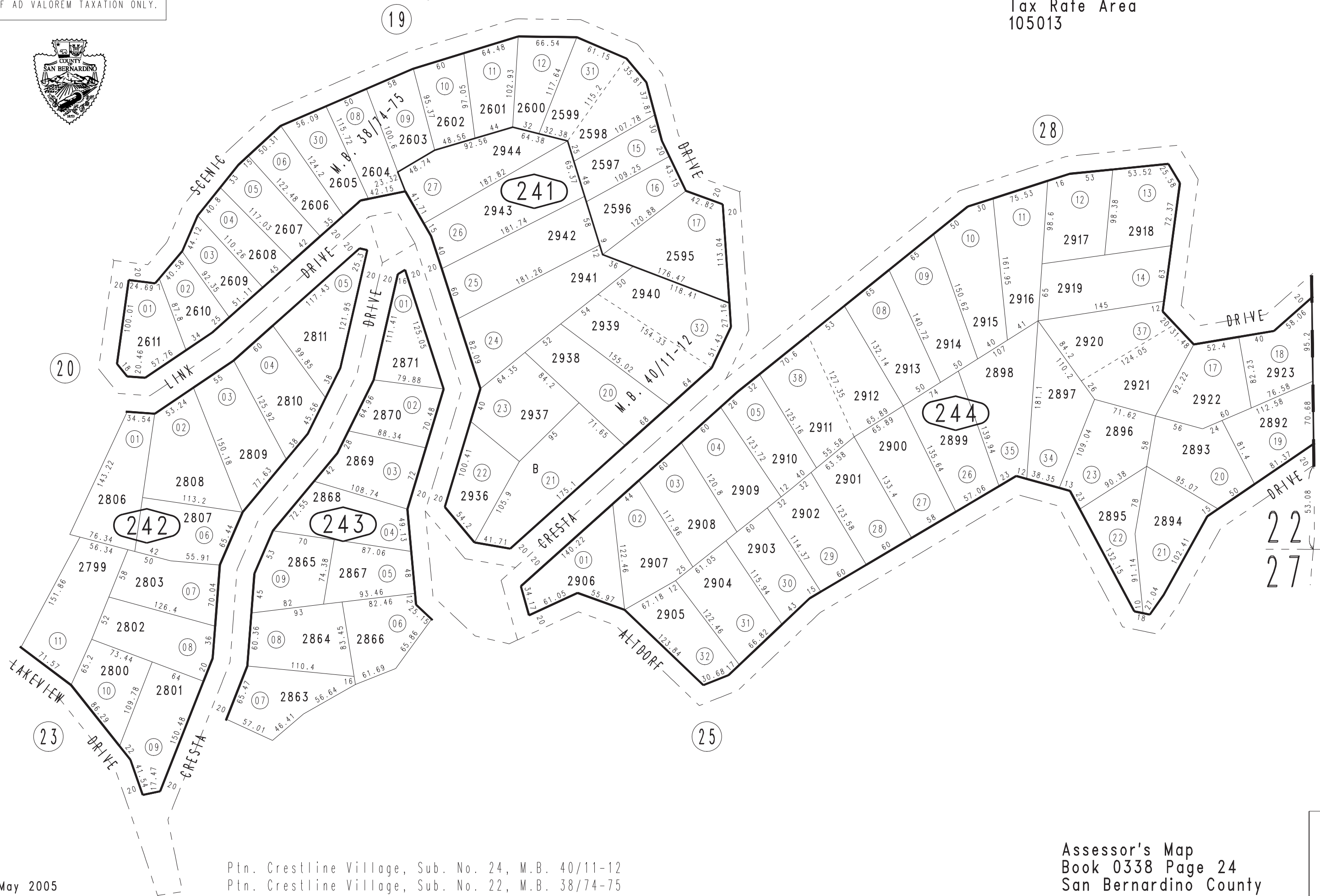

0337
26

22 23
27 26

Ptn. Crestline Village, Sub. No. 24, M.B. 40/11-12
Ptn. Crestline Village, Sub. No. 22, M.B. 38/74-75

Assessor's Map
Book 0338 Page 24
San Bernardino County

REVISED
06/26/07 LH
09/14/12 KC-MC

May 2005