

THIS MAP IS FOR THE PURPOSE OF AD VALOREM TAXATION ONLY.



# INDEX MAP BOOK 3057 CITY OF HESPERIA



BK.  
0405

BK.  
3064

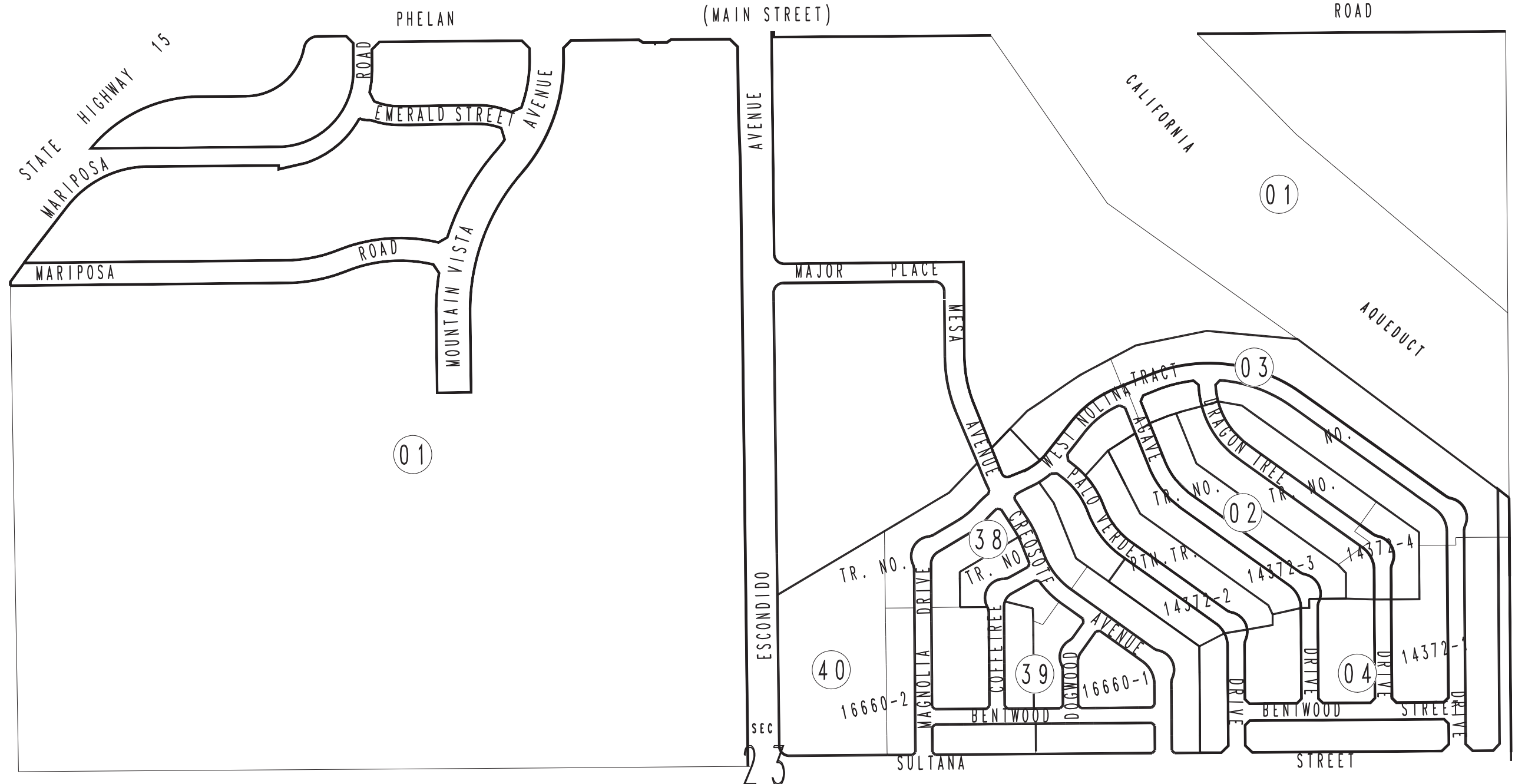

T. 4 N., R. 5 W.

05

Assessor's Index Map  
Book 3057  
San Bernardino County

REVISED  
05/09/06 GW